



ENVASES SANZ BELDA, S.L.

Tel.: 34 96 236 02 32 - calidad@envasesanzbelda.es - www.envasesanzbelda.es
Pol. Ind. San José. Avda, Valencia, parc. 7 - Apdo. de Correos 46 - 46812 Aielo de Malferit, Valencia. (España)



Technical comercial data

R-0.85-UN T.R-1.25

Serie ROSCA – Versión 28-02-2024

Approved UN 1H2/Y0.9/S Group II and III solids with inner bag only for tablets, marked with a danger triangle for blind people.

TECHNICAL DATA:

Material:	PP copolymer of first quality.
Colours:	White standard. Consult for other colours.
Useful Volume:	0.80 litres
Volume to the edge:	0.85 litres
Weight of the tub:	42 g. approx.
Weight of the lid:	24 g. approx.
Total Weight:	66 g. approx.
Design surface photographic finish	65 x 310 mm (height x perimeter)



MEASUREMENTS:

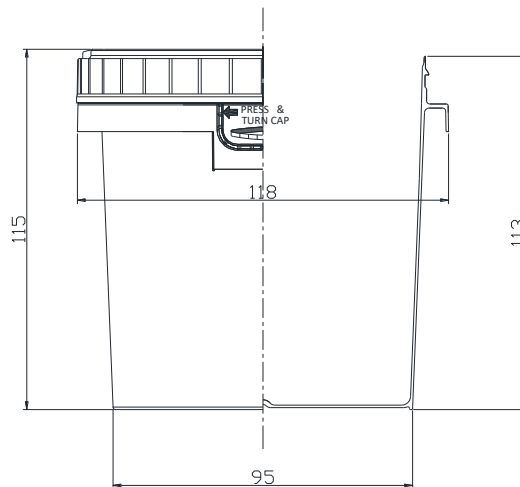

Measurements in millimetres

GROUPING OF TRANSPORT:

Tubs:	5.184 tubs per pallet 144 tubs per box, this serves as a packaging of transportation
Box dimension:	370 x 370 x 665
Pallet dimensions:	1095 x 1460 x 2135 (see drawing)
Lids:	288 per box, this serves as a packaging of transportation
Box dimension:	355 x 355 x 640

